



**FLORIDA DEPARTMENT OF TRANSPORTATION
US 27 AT STATE ROAD 78 CONCRETE INTERSECTION RECONSTRUCTION
SR 78 ROAD CLOSURE FROM US 27 AND INDUSTRIAL DRIVE DETOUR ROUTES**

Financial Project ID: 441977-1

April 2025
Glades County, FL

SR 78 ROAD CLOSURE FROM US 27 AND INDUSTRIAL DRIVE

As part of the Florida Department of Transportation’s intersection reconstruction project, SR 78 will be closed between US 27 and Industrial Drive from early April through May 2025 to allow for roadway reconstruction.

DETOUR DETAILS

- SR 78 will be closed to all traffic between US 27 and Industrial Drive.
- Both east and westbound turn lanes from US 27 to SR 78 will be closed.
- Traffic to and from SR 78 should follow the signed detour via Industrial Drive.
- Eastbound US 27 will remain a work zone throughout this period, but traffic in both east and westbound directions on US 27 will remain open.

DETOUR MAP

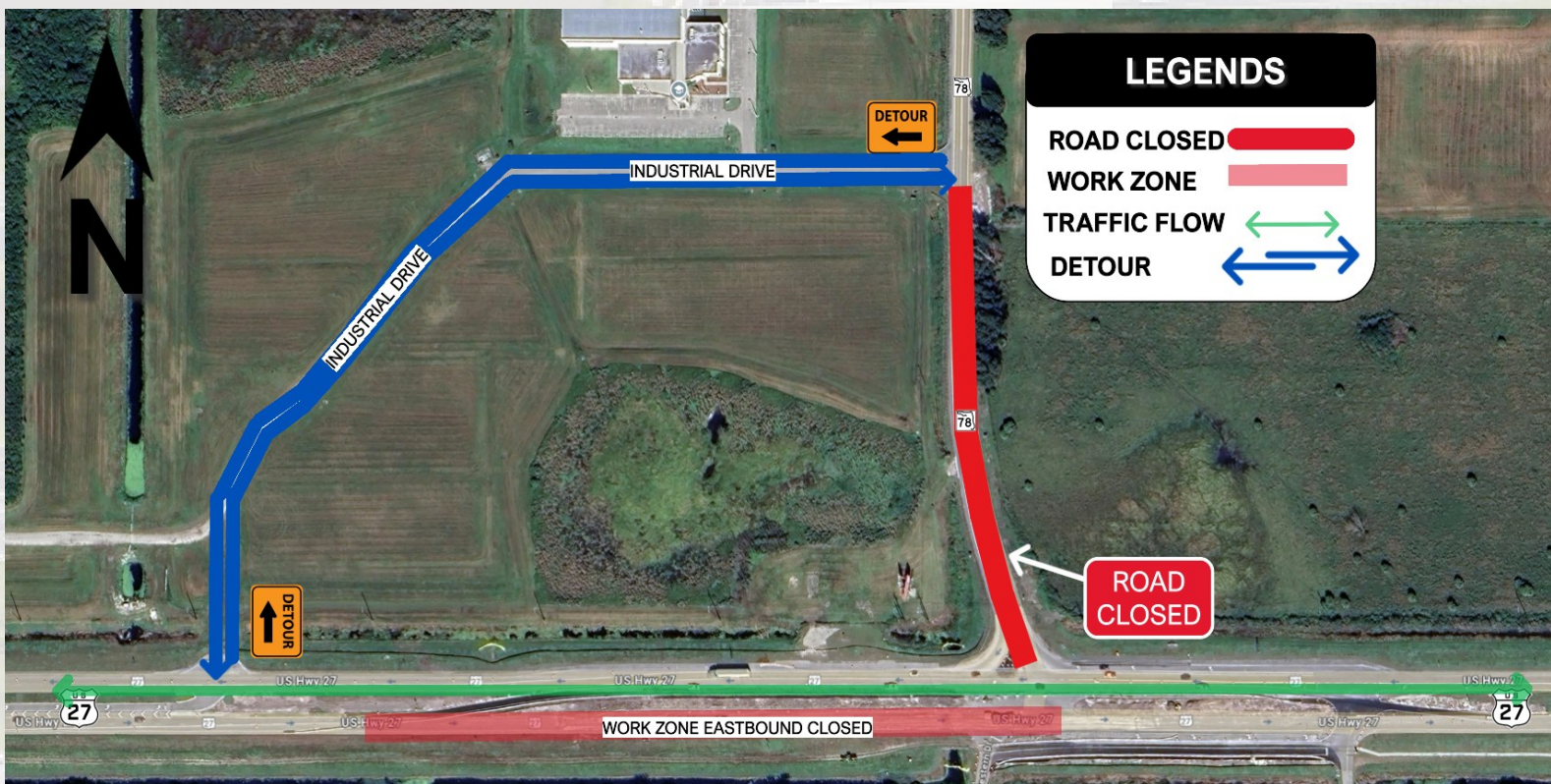

CONTACT US

Aika Ranieri
Community Outreach Specialist
(863) 464-0743
Ai.Ranieri@dot.state.fl.us

or

Janella Newsome
Director of Public Information
(863) 519-2828
Janella.Newsome@dot.state.fl.us

FOLLOW US

www.SWFLroads.com | [X.com/MyFDOT_SWFL](https://x.com/MyFDOT_SWFL) | facebook.com/MyFDOTSWFL | instagram.com/myfdot_swfl