

STATE OF FLORIDA DEPARTMENT OF TRANSPORTATION
TECHNICAL REPORT COVERSHEET

650-050-38
ENVIRONMENTAL
MANAGEMENT
06/17

DRAFT SECTION 4(f) NO USE DETERMINATION

Florida Department of Transportation

District 1

SR 70

Limits of Project: from Lorraine Road to CR 675/Waterbury Road

Manatee County, Florida

Financial Management Number: 414506-2

ETDM Number: 14263

Date: JULY 2019

The environmental review, consultation, and other actions required by applicable federal environmental laws for this project are being, or have been, carried out by FDOT pursuant to 23 U.S.C. § 327 and a Memorandum of Understanding dated December 14, 2016 and executed by FHWA and FDOT.

FLORIDA DEPARTMENT OF TRANSPORTATION
SECTION 4(F) NO USE DETERMINATION

650-050-49
Environmental
Management
06/17

Project Name:	SR 70 from Lorraine Road to CR 675/Waterbury Road		
FM#:	414506-2-22-01	ETDM#:	14263
Project Review Date:	6/12/2019		
FAP#:			
FDOT District:	1		
County(ies):	Manatee County, Florida		

Project Description including Section 4(f) Specific Information:

The Florida Department of Transportation (FDOT) is conducted a Project Development and Environment (PD&E) study to evaluate the proposed widening of 6.1 miles of State Road (SR) 70 from Lorraine Road (MP 9.478) to County Road (CR) 675/Waterbury Road (MP 15.567) in Manatee County. The proposed action is to increase the capacity of the existing two-lane undivided roadway by widening it to a four or six lane divided roadway to accomplish the purpose and need. The Premiere Sports Campus is located in Section B which is 4 lanes expandable to 6 lanes. No right-of-way will be aquired at this location.

Type of Property: Public Parks and Recreation Areas

Description of Property: Premier Sports Campus is an outdoor venue with 22 fields which host a range of sports such as soccer, lacrosse & football.

Establishing Section 4(f) Use of the Property

Will the property be "used" as defined in **Section 4(f)** Resources chapter of the FDOT PD&E Manual? Examples of a "use" include but are not limited to new right of way, new easements, and temporary occupancy?

- Yes
 No

An explanation of the relationship between the Section 4(f) property and the project:

Premier Sports Campus is adjacent to the project limits. Because the property is owned by Manatee County, this resource is considered under Section 4(f) the U.S. Department of Transportation Act of 1966. In the Premier Sports Campus area, the project will be built entirely within existing right-of way, and no impacts to park access are anticipated. Therefore, the official with jurisdiction was not contacted.

Documentation

The following items **must** be attached to this form to ensure proper documentation of the Section 4(f) No Use:

1. DOA form and documentation (*Including the Form and Attachments*)
2. Required communications with the OWJ

Signatures

The environmental review, consultation, and other actions required by applicable federal environmental laws for this project are being, or have been, carried out by FDOT pursuant to 23 U.S.C. 327 and a Memorandum of Understanding dated December 14, 2016, and executed by FHWA and FDOT.

Signature: Nicole Selly Digitally signed by Nicole Selly
DN: cn=US, e=nicole.selly@ksingercampo.com,
o="Ksinger Campo and Associates",
ou="PD&E", dn=Nicole Selly
Reason: I am the author of this document
Date: 2019.07.09 22:51:04 -0400 7/9/2019
Preparer Date

Signature: Dwight Papken 7-11-19
Environmental Manager, or designee Date

FLORIDA DEPARTMENT OF TRANSPORTATION
SECTION 4(F) NO USE DETERMINATION

650-050-49
Environmental
Management
06/17

**OEM
Concurrence:**

Signature: _____ Date _____
Director of OEM, or designee

DRAFT

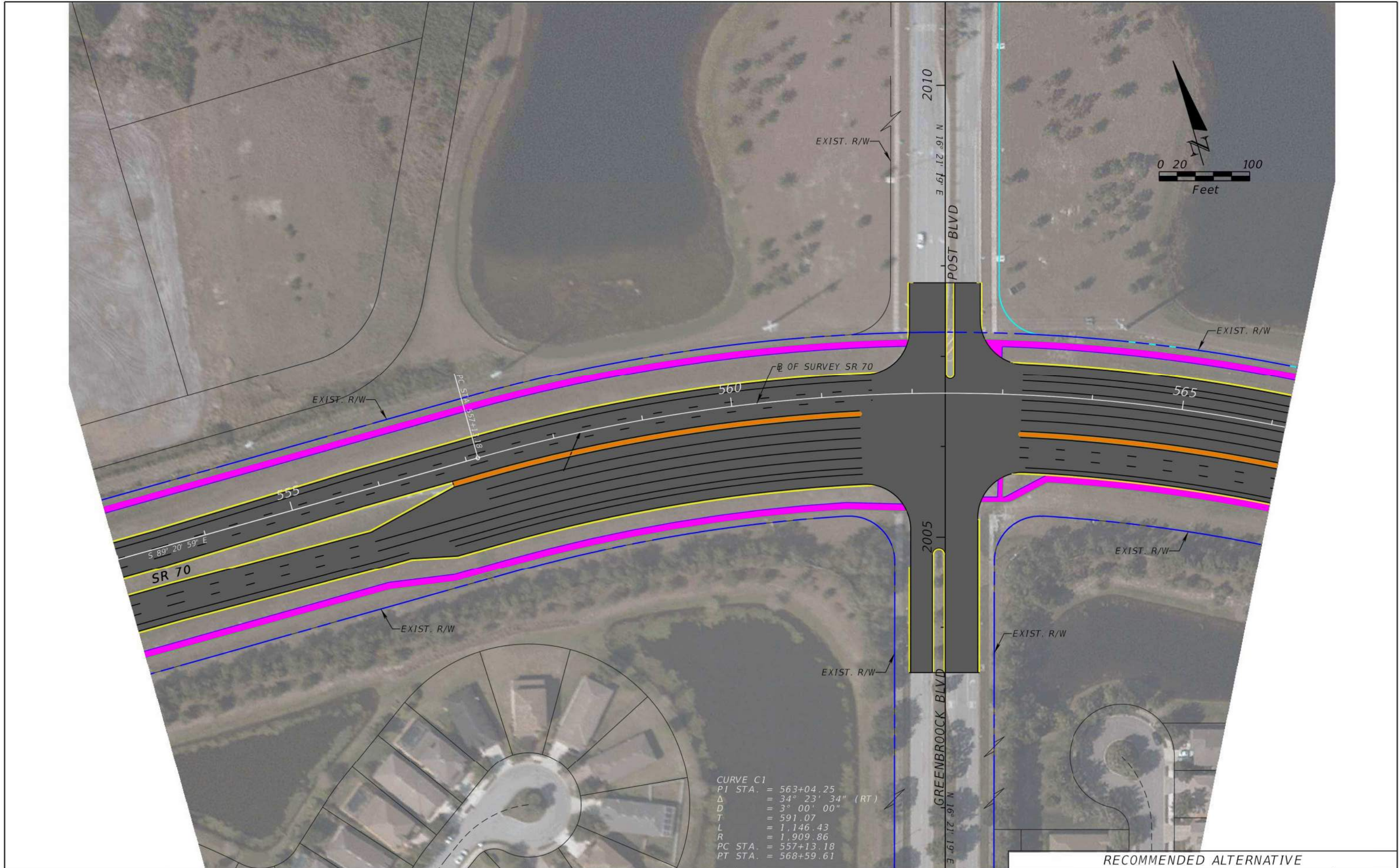

CURVE C1
 PI STA. = 563+04.25
 Δ = 34° 23' 34" (RT)
 D = 3° 00' 00"
 T = 591.07
 L = 1,146.43
 R = 1,909.86
 PC STA. = 557+13.18
 PT STA. = 568+59.61

LEGEND

- | | | |
|------------------------------|-------------------|-----------------------|
| EXISTING R/W LINE | PROPOSED ROADWAY | MILLING & RESURFACING |
| PROPOSED R/W LINE | TRAFFIC SEPARATOR | WETLANDS |
| PROPERTY LINE | ROUNDABOUT APRON | PUBLIC LANDS |
| POTENTIAL CONTAMINATION SITE | PROPOSED SIDEWALK | SURFACE WATERS |
| | PROPOSED BRIDGE | |

Kisinger Campo & Associates Corp.
 201 E. Franklin Street, Suite 400
 Tampa, Florida 33602
 Florida Certificate of Authorization No. 02317
 Engineer of Record: Deborah Hernandez-Cedeno, P.E.
 P.E. No.: 74754

STATE OF FLORIDA
 DEPARTMENT OF TRANSPORTATION

ROAD NO.	COUNTY	FINANCIAL PROJECT ID
SR 70	MANATEE	414506-2-22-01

RECOMMENDED ALTERNATIVE

CONCEPT PLAN (A)
 STA. 153+00 TO STA. 166+00

SHEET NO.

5

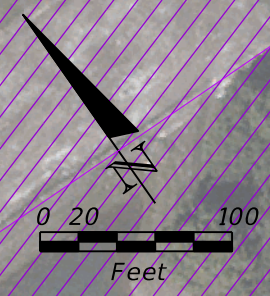

PREMIER SPORTS CAMPUS

EXIST. R/W

PT. STA. 568+59.61
EQUATION:
STA 568+59.61 BK =
STA 568+71.49 AH

570

575

S 54° 57' 25" E

S 54° 57' 25" E

SR 70

B OF SURVEY SR 70

EXIST. R/W

BRANDON RIVER
MITIGATION BANK

LEGEND

	EXISTING R/W LINE		PROPOSED ROADWAY		MILLING & RESURFACING
	PROPOSED R/W LINE		TRAFFIC SEPARATOR		WETLANDS
	PROPERTY LINE		ROUNDBOUT APRON		PUBLIC LANDS
	POTENTIAL CONTAMINATION SITE		PROPOSED SIDEWALK		SURFACE WATERS
			PROPOSED BRIDGE		

Kisinger Campo & Associates Corp.
201 E. Franklin Street, Suite 400
Tampa, Florida 33602
Florida Certificate of Authorization No. 02317
Engineer of Record: Deborah Hernandez-Cedeno, P.E.
P.E. No.: 74754

STATE OF FLORIDA DEPARTMENT OF TRANSPORTATION		
ROAD NO.	COUNTY	FINANCIAL PROJECT ID
SR 70	MANATEE	414506-2-22-01

RECOMMENDED ALTERNATIVE

CONCEPT PLAN (5)
STA. 166+00 TO STA. 179+00

SHEET NO.
6

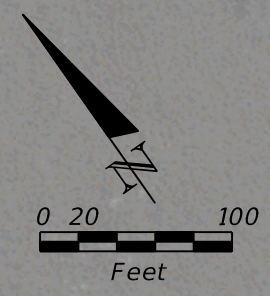

PREMIER SPORTS CAMPUS

BRANDON RIVER MITIGATION BANK

BRANDON RIVER MITIGATION BANK

580

585

590

B OF SURVEY SR 70

EXIST. R/W

EXIST. R/W

LEGEND

EXISTING R/W LINE	PROPOSED ROADWAY	MILLING & RESURFACING
PROPOSED R/W LINE	TRAFFIC SEPARATOR	WETLANDS
PROPERTY LINE	ROUNDABOUT APRON	PUBLIC LANDS
POTENTIAL CONTAMINATION SITE	PROPOSED SIDEWALK	SURFACE WATERS
	PROPOSED BRIDGE	

Kisinger Campo & Associates Corp.
 201 E. Franklin Street, Suite 400
 Tampa, Florida 33602
 Florida Certificate of Authorization No. 02317
 Engineer of Record: Deborah Hernandez-Cedeno, P.E.
 P.E. No.: 74754

STATE OF FLORIDA DEPARTMENT OF TRANSPORTATION		
ROAD NO.	COUNTY	FINANCIAL PROJECT ID
SR 70	MANATEE	414506-2-22-01

RECOMMENDED ALTERNATIVE

CONCEPT PLAN (6)
STA. 179+00 TO STA. 193+00

SHEET NO.
7